

### Section A - A' - existing staircase

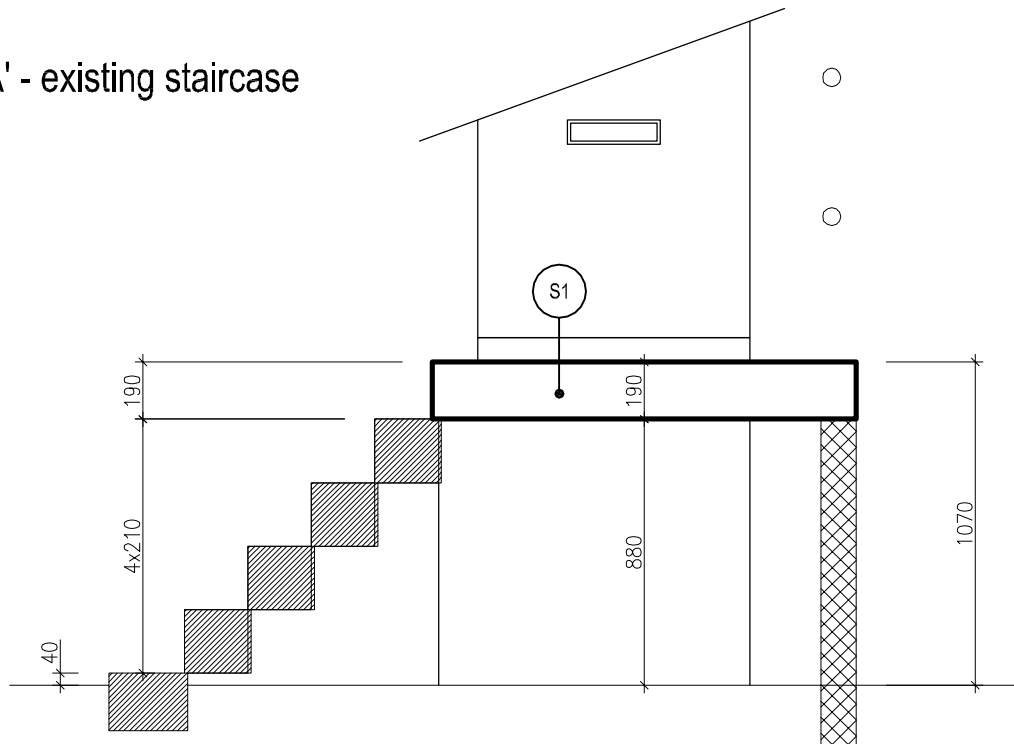

(S1) Reinforced concrete (RC) slab to removed.

### Section A - A' - new RC slab/brickwork

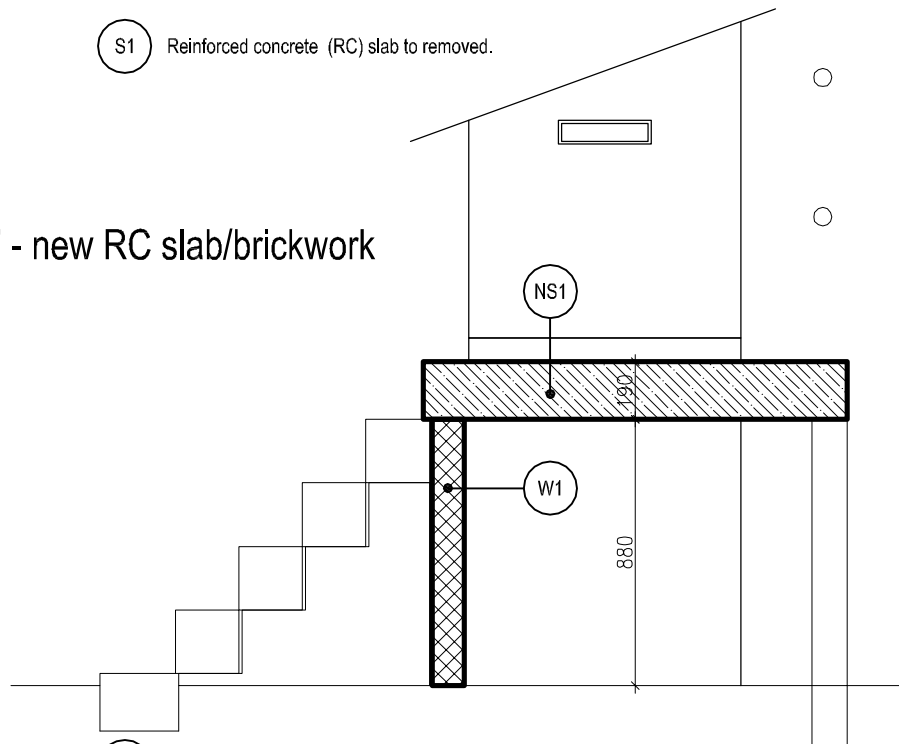

(NS1) New reinforced concrete (RC) slab, 1400 x 720 x 190 mm.

(W1) New brickwork supporting RC slab.

Client:  
Toni Cushman  
21 Elmcroft Ave., Wansted, London

PROJECT	-	SCALE	1 : 25	DATE	02/2009	#/M	1xA4	PAGE NUMBER	1	DUPL.	
---------	---	-------	--------	------	---------	-----	------	-------------	---	-------	--